

CHILDREN'S BATTERY OPERATED ATV

With Remote Control Function



OWNERS MANUAL

Read and understand this entire manual before using!

Please keep this manual for future reference as it contains important information.

Our products are suitable for ASTM F963; GB6675; EN71 and EN62115 standard.



WARNING:

- **CHOKING HAZARD!** Not suitable for children under 3 years.
- **ADULT ASSEMBLY REQUIRED.**

About Your New Vehicle

On the purchase of your new Ride-On.

This ride-on car will provide your child with many miles of riding of enjoyment. To help assure you and your rider a safe ride we ask you to please read this manual carefully, and keep it for future reference.

Specification

Suitable age:	3+ years
Battery:	12V7AH x1
Charge time:	8-12 hours
Charge:	Input: depend on local voltage output: DC12V1000mA
Load capacity:	under 35 kg
Size of car:	113 x 74 x 77 cm
Speed:	3.5km/h



PREVENT INJURIES AND DEATHS:

- **NEVER LEAVE CHILD UNATTENDED. ADULT DIRECT SUPERVISION IS REQUIRED.** Always keep child in view when child is in vehicle.
- This toy should be used with caution since skill is required to avoid falls or collisions causing injury to the user or third parties.
- Protective equipment should be worn.
- Not to be used in traffic.
- This toy is unsuitable for children under 36 months due to its maximum speed; Maximum user weight is 35 kg.
- This toy has no brake.

Parts List

NO.	PART NAME	Q'TY (PCS)	REMARK
1	Vehicle body	1	
2	Gear box	1	
3	Driving heel	2	
4	Φ12 washer	3	
5	Rear axle	6	
6	Hubcap	4	
7	Front wheel	2	
8	Front axle	1	
9	Φ4x12 screw	8	
10	Rear axle	1	
11	Handle bar	1	
12	M5x35 machine screw	1	
13	Φ5 nut	1	
14	Seat	1	
15	Φ4x10 screw	1	
16	Back rest	1	
17	Spanner	2	
18	Charger	1	
19	Φ10 washer	1	
20	Remote controller	1	



BATTERY INFORMATION

- Non-rechargeable batteries are not to be recharged.
- Rechargeable batteries are to be removed from the toy before being charged.
- Rechargeable batteries are only to be charged under adult supervision.
- Different types of batteries or new and used batteries are not to be mixed.
- Batteries are to be inserted with the correct polarity.
- Exhausted batteries are to be removed from the toy.
- The supply terminals are not to be short-circuited.

Parts Diagram

HINT: Some parts shown are assembled on both sides of vehicle

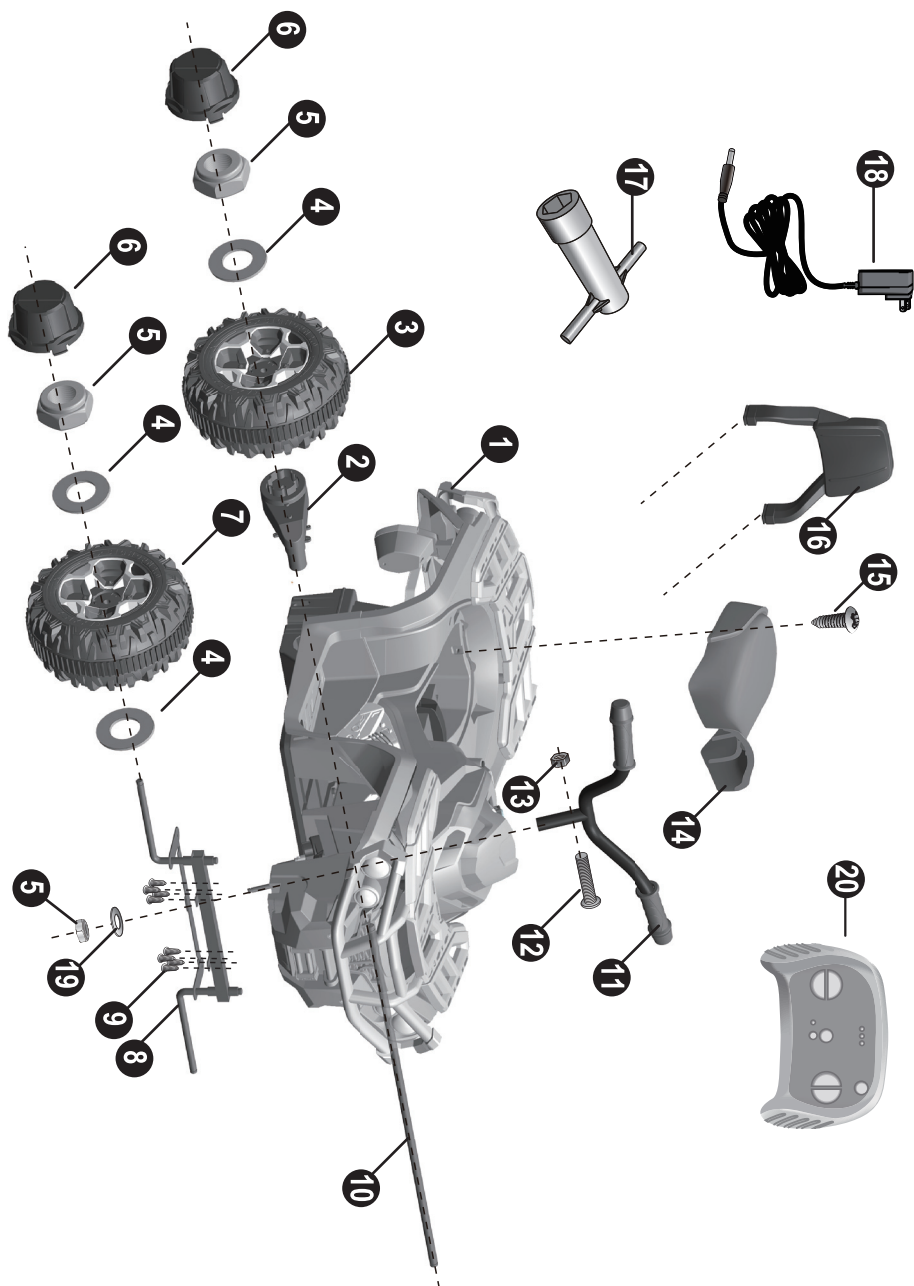

Assembly

Front bottom view

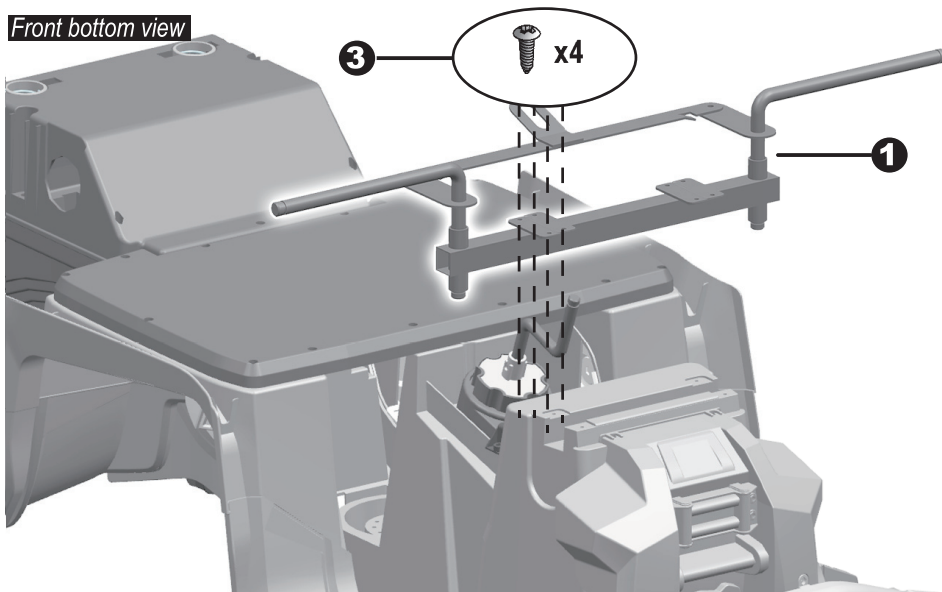

Front bottom view

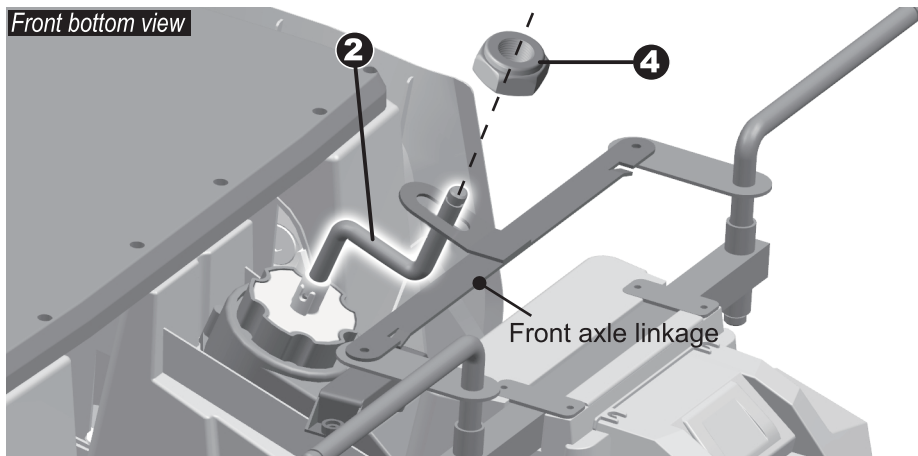

1. Turn the vehicle body downside up. Fit the front axle against to vehicle body.
2. Ensure the bent end of the steering column passes through the hole on the front axle linkage.
3. Insert eight screws through the front axle and into the vehicle body, tighten with a screwdriver.
4. Tighten a locknut to the bent end of the steering column with a spanner.

Assembly

Front bottom view

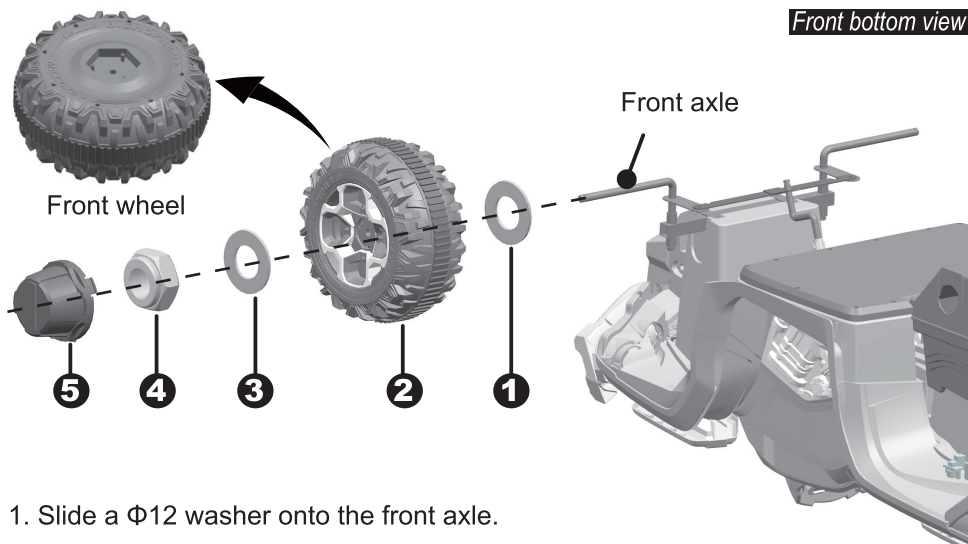

1. Slide a $\Phi 12$ washer onto the front axle.
 2. Slide a front wheel onto the front axle.
 3. Slide a $\Phi 12$ washer onto the front axle.
 4. Tighten a lock nut to the end of the front axle with a spanner.
 5. “Snap” the hubcap to the wheel.
- Repeat to the other side.
6. Insert the rear axle into the hole on the vehicle.;

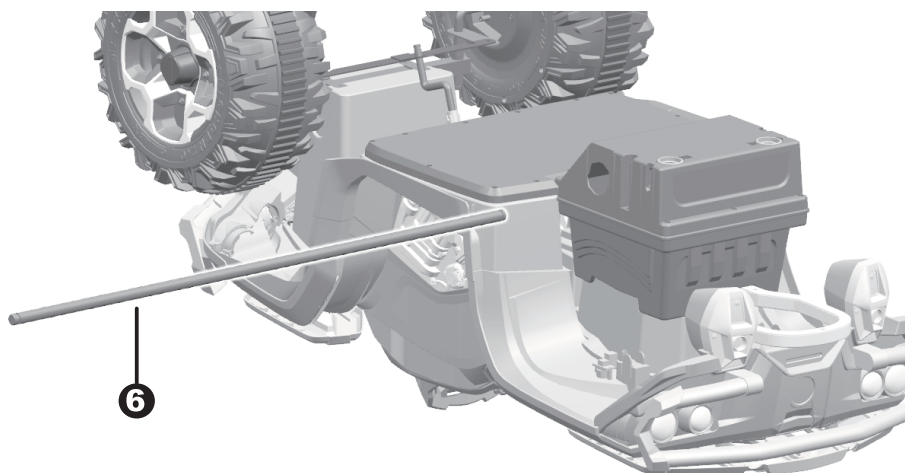

Assembly

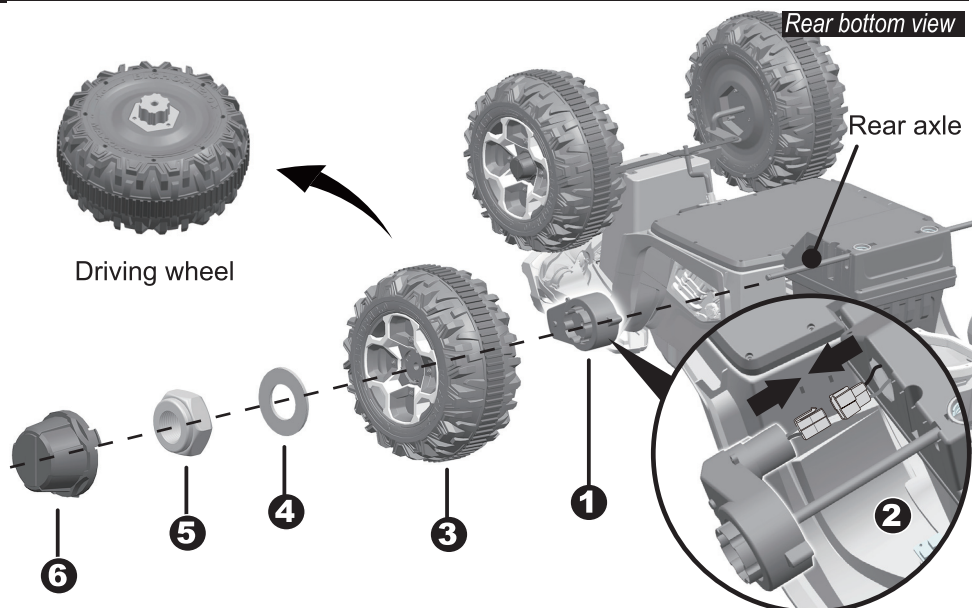

1. Slide a gear box onto the rear axle. "R" labeled gear box should be fit to the R side of vehicle body, "L" labeled gear box should be fit to the L side of vehicle body.
2. Plug the connector on the gear box into the connector on the vehicle.
3. Slide a driving wheel onto the rear axle.
4. Slide a $\Phi 12$ washer onto the rear axle.
5. Tighten a lock nut to the end of the rear axle with a spanner. Repeat to the other side.

● HINT: An extra spanner has been provided to hold the Lock Nut on the other side of the rear axle while tightening the lock nut on the other side.

6. "Snap" the hubcap to the wheel.
- Turn the vehicle body upright.

7. Fit the handle bar tube to the end of the steering column.
8. Align the holes on each side of handle bar with the holes at the end of the steering column.

9. Fasten a nut on the opposite end of the screw to secure the steering wheel to the steering column.

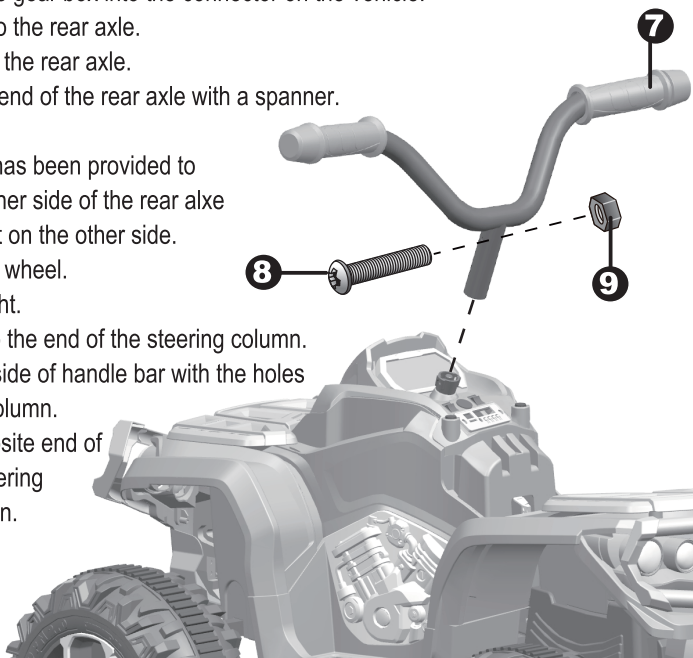

Assembly

Seat inside view

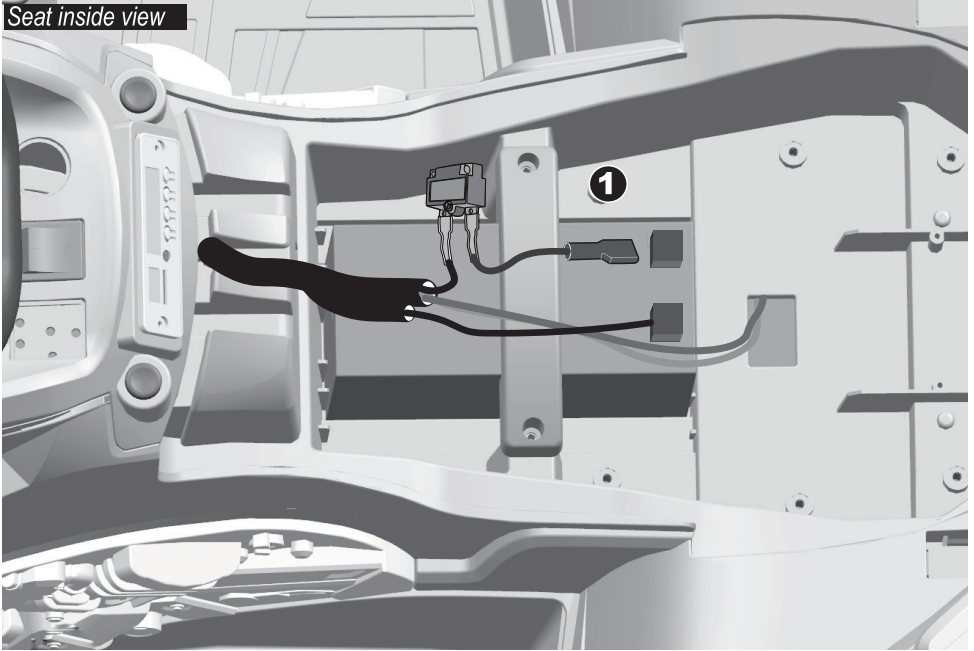

1. Plug the red fuse connector into the terminal on battery.
2. Fit the seat to the vehicle body.
3. Tighten a $\phi 4 \times 10$ screw to secure the seat.

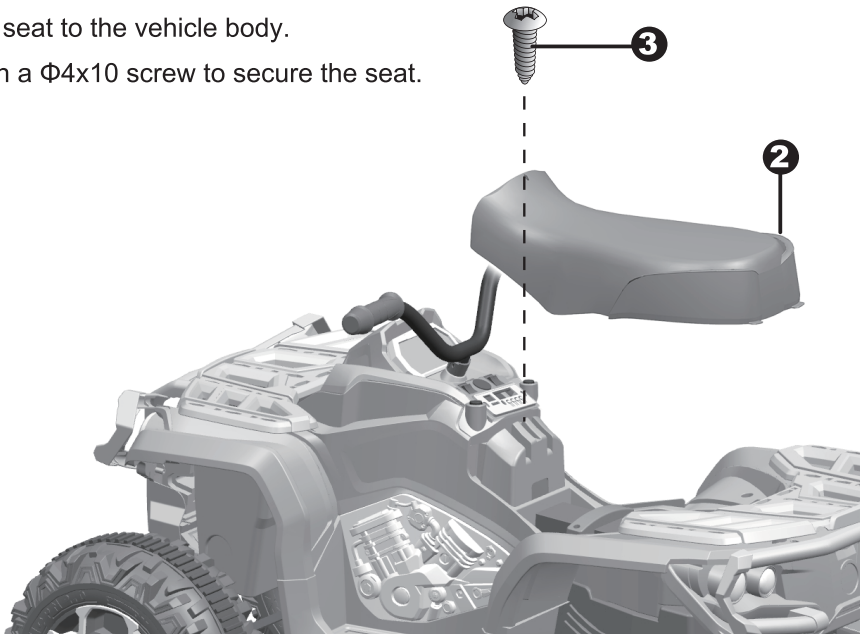

Assembly

1. Insert the tabs on the back rest into the slots on the rear of the vehicle. Push it until you hear it “click” into place.

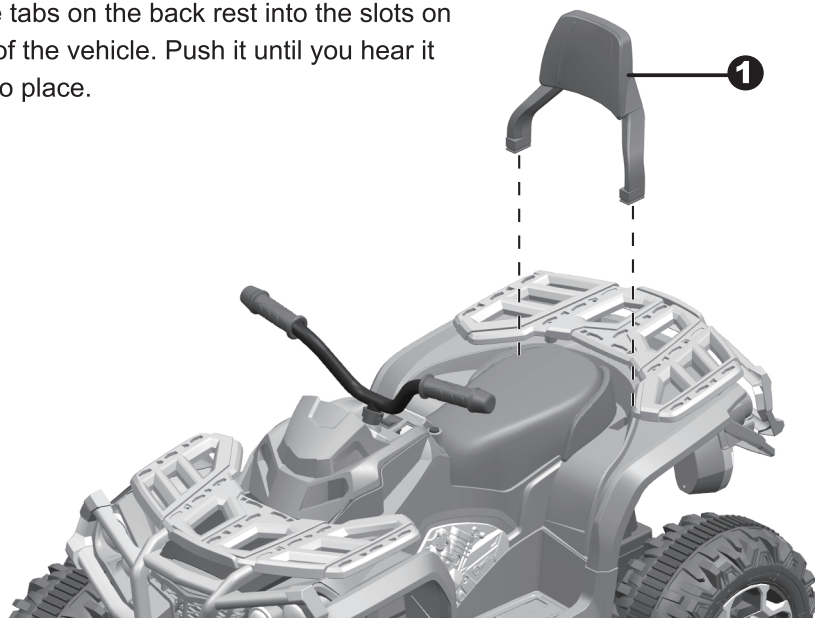

Use Your New Ride-on

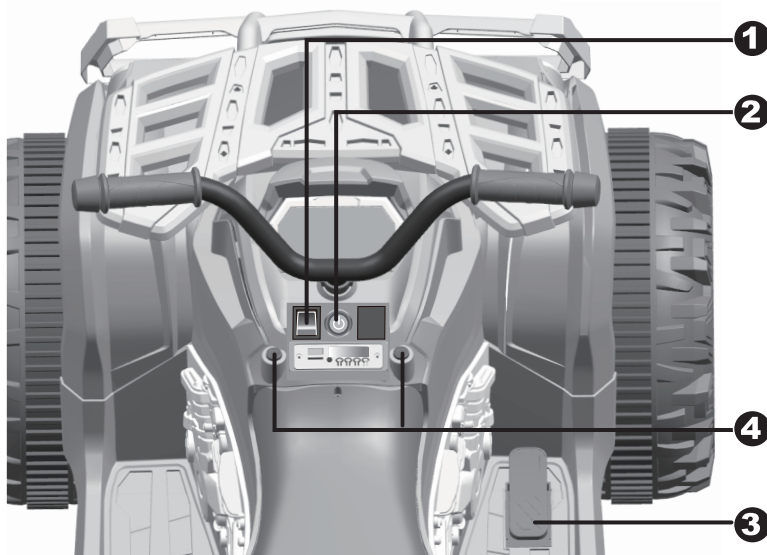

Use Your New Ride-on

1. Forward/Reverse switch:

Changes the direction that vehicle moves from forward to reverse.

2. Power Switch:

Turns the vehicle on and off.

3. Foot pedal:

Applies power (speed) to the ride-on.

- To move the ride-on, press the pedal down.
- To brake or slow down, release pressure from the pedal.

4. Sound buttons:

Press for sound playing.

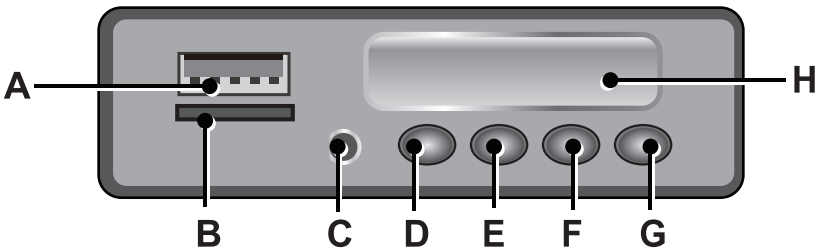

A. USB slot

B. TF card slot (Read mp3 format only)

C. AUX input

D. Previous / Increase volume

E. Play / Pause

F. Next / decrease volume

G. Change the audio input (If you insert two or more audio input devices). It also controls the bluetooth and FM functions.

H. Display screen: It displays the power level of the battery when the vehicle stops. When the numerical value is less than 12, recharge the battery please.

Use the Remote Controller

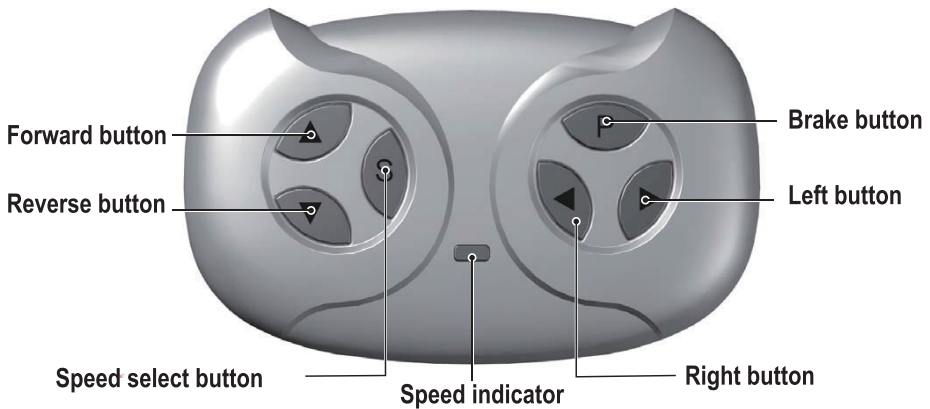

Attach the batteries of controller

Lift the battery compartment door on the back of the controller and insert two AAA(LR03) batteries.

HINT: Batteries not included. Refer to the Battery Information on page 2.

1. Build connection

Long press the forward and reverse buttons for 3 seconds, and the speed indicator flashes. Then power on the vehicle, the speed indicator goes to long bright, means the connection successful. If the speed indicator no response, means the connection failed. Replace the batteries and retry.

2. Brake button

Press the button to stop the vehicle, press it again to release the brake.

3. Speed select button

The switch operates the vehicle to move in low, normal or high speed.

HINT: This switch won't work while your vehicle moves reverse.

NOTE:

- Leave the remote controller idling for about 10 seconds, it will shut down automatically.
- Rebuild connection when you replace the batteries of the remote controller.

Charging

- The POWER SWITCH must be turned in **OFF** position when charging.
- Do not recharge the battery for more than 10 hours to avoid overheating the charger.
- When the vehicle begins to run slowly, recharge the battery.
- After each use or once a month minimum recharge time as 8 to 12 hours, less than 20 hours at most.

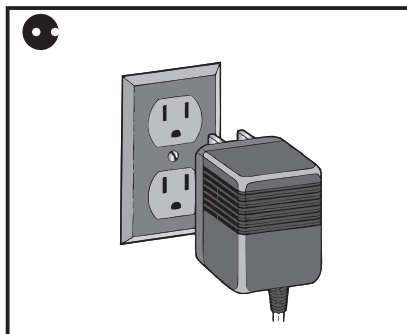
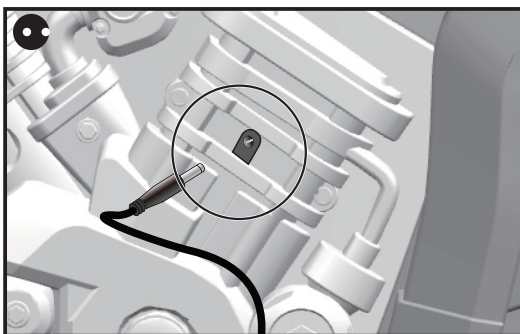

1. Plug the charger port into the input socket. (above the fool pedal)
2. Plug the charger plug into a wall outlet. The battery will begin charging.

Disposal Of Battery



- Your sealed lead-acid battery must be recycled or disposed of in an environmentally sound manner.
- Do not dispose of your lead-acid battery in a fire. The battery may explode or leak.
- Do not dispose of a lead-acid battery in your regular, household trash. The incineration, land filling or mixing of sealed lead-acid batteries with household trash is prohibited by law.

Our products are suitable for ASTM F963; GB6675; EN71 and EN62115 standard.